

Gabarrón

TPG-IR

MANDO A DISTANCIA INFRARROJO

1 INTRODUCTION

The remote control allows setting temperature values and operation schedules in order to configure the heaters through infrareds.

The main functions are:

- Hourly programming (weekly programming)
- Setting temperature values in the premises
- Temporal suspension of automatic programming

Various preset programs in the IR remote control are to be transmitted through IR to every heater available in the premises.

Contents:

- Remote control unit
- Remote control holder
- Battery set

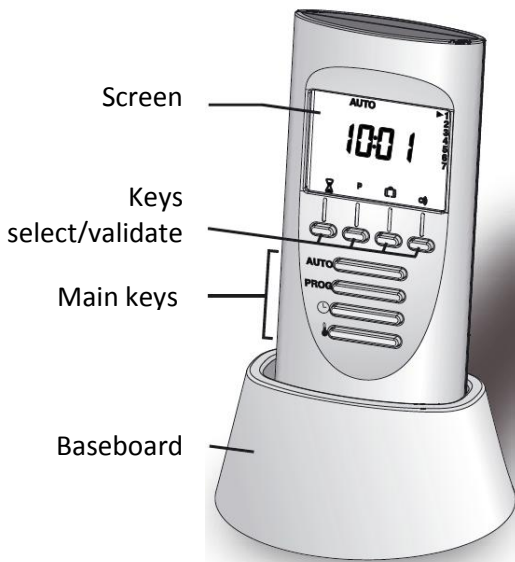

Validation keys:

C	Exit	P	Program selection		Absence mode		Transmission
	Compulsory mode	+	Adjustment +	-	Adjustment -	OK	Validation
	Comfort mode		Economy mode		Frost protection mode		

2 STARTING

Open the battery lid located at the back part of the remote control.

1. Remove the battery lid.
2. Remove the battery protection film.
The remote control must turn on.
3. Install back the battery lid.

Picture: remove the battery protection film.

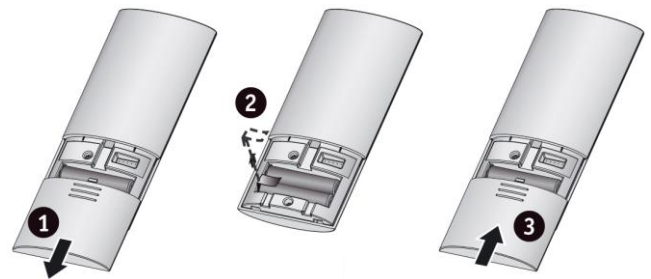

The batteries discharge is indicated on the LCD display by the specific sign:

The backlit of the display is off once the remote control batteries are discharged.

There is one minute time lapse to replace the batteries before losing time and program settings.

3 PROGRAMMING

The remote control unit has:

- 4 main keys (wide keys)
- **AUTO**: key AUTO
- **PROG**: programming key
- Time settings key
- Temperature setting key
- Other 4 keys, select validation, its function corresponds to the picture indicated at the Bottom of the display.



Main keys are priority keys over validation keys.

4 TIME SETTINGS

- Press the watch key , the days 1 to 7 will start blinking.
- Choose the corresponding number of the day of the week: 1 for Monday, 2 for Tuesday, etc.
- Validate pressing **OK**.

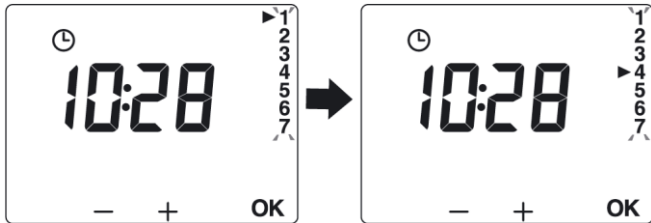

The screen will pass to the hour selection.
The hour digits will blink (left side).

- Program the actual hour pressing the keys **+** or **-**
- Validate pressing **OK**



The screen will pass to selection of minutes.
The digits of minutes will blink (right side).

- Program the actual minutes pressing the keys **+** or **-**
- Validate pressing **OK**



The remote control is waiting the transmission to the receivers. Direct the remote control unit at the receiver (the heater) and press the key , the transmission will start (processing ----)

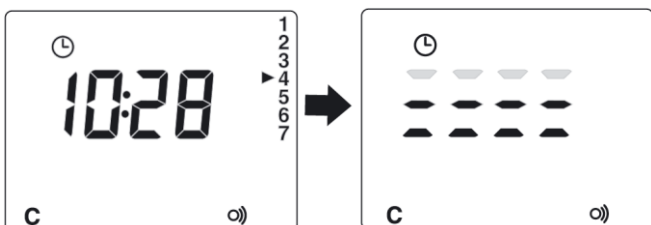

5 TEMPERATURE SETTINGS

The default temperature settings are:

- Comfort -19°C, Economy -16°C and Frost Protection -7°C (not programmable)
- Adjust with **+** or **-** by 0,5°C steps.

Comfort temperature adjustment (5°C to 30°C).

- Press the Temperature Key  on the remote control, first **Comfort** temperature will be offered.
- Increase pressing **+** or decrease pressing **-**.
- Validate, pressing **OK**.



Economy temperature adjustment (5°C to 30°C).

- The remote control will switch to the **Economy** temperature.
- Increase pressing **+** or decrease pressing **-**.
- Validate pressing **OK**.



Frost Protection temperature (7°C).

- The remote control will switch to the **Frost Protection Temperature** with the value 7°C.
- Validate, pressing **OK**.



The remote control will wait for the transmission to the receivers. Direct the remote control unit at the receiver (the heater) and press the key , the transmission will start (processing ----)

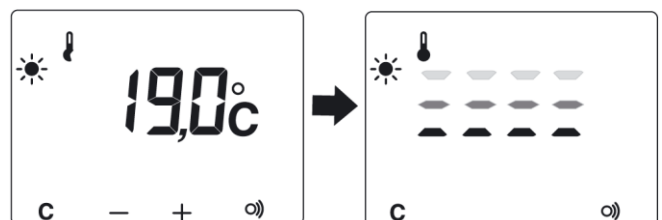

6 PROGRAMS

The remote control has:

- 3 preset programs, P1, P2, P3 and
- 3 programs to be set by the user P4, P5, P6

Programs P1 to P3 are not to be modified, they are factory set.

Factory set programs P1 to P3:

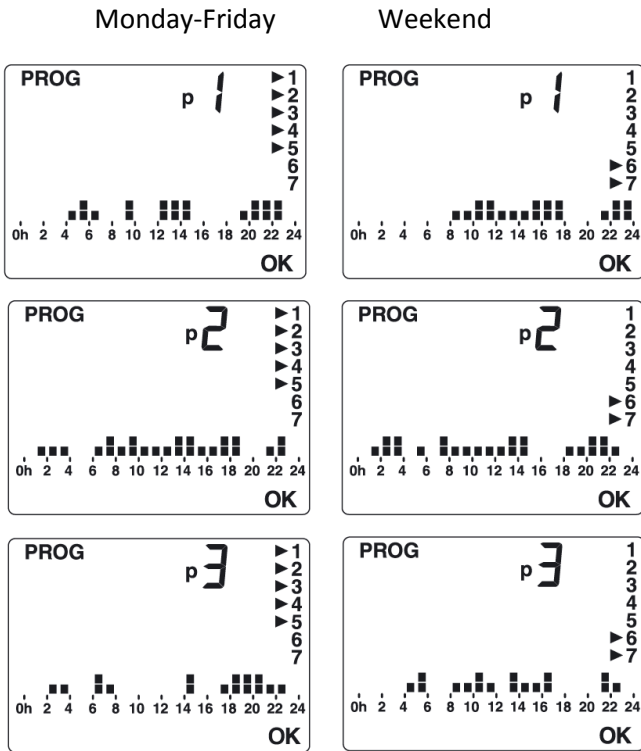

The user should go to programs P4 to P6 in order to create user-defined programs.

Example of programing:

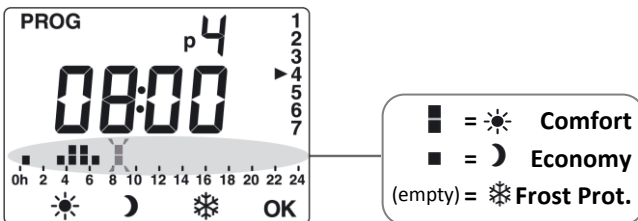

- Press the key **PROG**.
- The remote control will offer the first preset program (P1).
- Pressing **OK** for two times, follow with the next program (P2).

Note: it is possible to reduce the programming pressing the key AUTO.

In order to modify a program (P4 to P6):

- Press the keys **Comfort** ☀/**Economy** 🌙/**Frost Protection** ❄ to select the mode.
- The cursor will move from one hour to another, meanwhile the screen will show the reference hour.

Note: by default the non-programmed timeline is set to **Frost Protection**.

- Validate with **OK** in order to pass to the next day and repeat the steps up to the day 7 (Sunday).

The long pressing OK key will copy the current day setting to the next day.

Arriving at day 7 the remote control will offer the next program.

7 AUTO Mode

In order to transmit programs to the heater:

- Press the **AUTO** Key
- Press the key **P** in order to select the program to be transmitted.

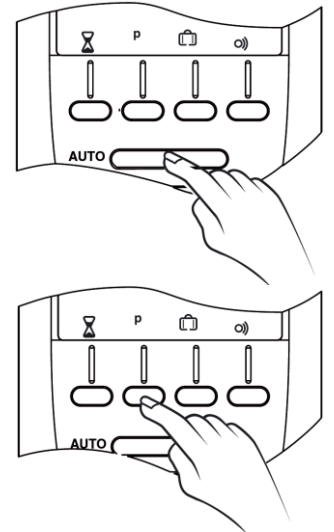

Example for P4

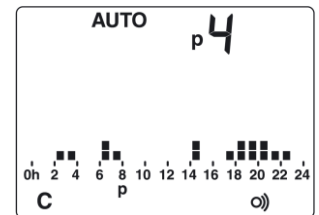

- Direct the remote control unit towards the receiver, press the **OK** key. The transmission will start (processing...).
- Wait for the approval of the emitter by display illumination.

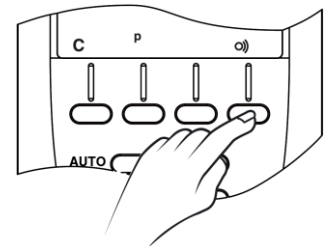

In case if there had not been implemented no programs from P4 to P6, all the values will be in Frost Protection.

8 PROGRAM STANDBY

It is possible to temporarily interrupt the operation in automatic mode applying one of two following procedures:

Forced mode: allows imposing the desired temperature value between 5 to 30°C during certain time period among 30 minutes and 72 hours.

Standby ⏸ (short periods)

- Press the key ⏸.
- Adjust the temperature from 5 °C to 30 °C with + or - (in 0,5 °C steps).
- Validate pressing **OK**.
- Direct the remote control towards the receiver, press the  key, the transmission will start (processing ----).
- Wait for the approval of the emitter by display illumination.

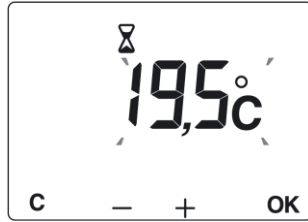

Absence mode: allows establishing the frost protection function during the absence period between 1 and 365 days.

Standby  (long periods)

- Press the key .
- Adjust the number of the days from 1 to 365 with + or - (1 day steps).
- Validate pressing **OK**.



When the time of any of these procedures is over, the emitters will continue with the program selected previously.

In order to revoke any of these procedures:

Press the key  to set **AUTO** mode.

9 KEYBOARD LOCK

In order to lock the remote control unit keyboard:

- Press simultaneously during 3 seconds, the 2 central validation keys until the “**bloc**” message will be displayed.

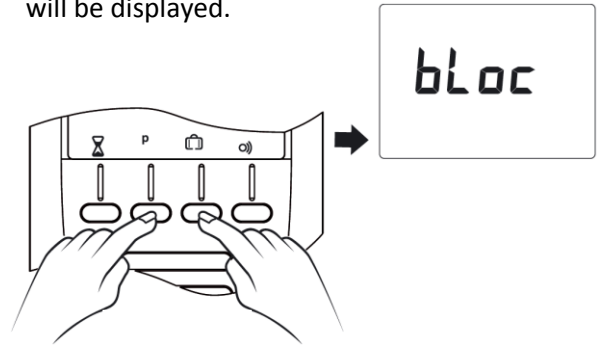

Note: in time of lock, pressing a key a “**bloc**” message will be displayed.

To unlock: the same thing is made,

- Press simultaneously during 3 seconds the 2 central validation keys.

10 TECHNICAL FEATURES

- Optical range: 3 meters directly.
- Power supply: 2 alkaline batteries R03 type.
- Autonomy: two years of regular service.
- Dimensions: 145 x 61 x 18 mm.
- Operation temperature +5C/+55C
- IP 3
- Box: ABS-PC
- Weight (with batteries): 150 g.



Note: the used batteries must be properly disposed in the specific containers for batteries recycling.

Gabarrón

www.elnur.es

ELNUR s.a.

Pol. Ind. “El Nogal” c/ Villa Esther, 11
28110. ALGETE – Madrid - Spain



Declares that the product is in compliance with the requirements of the EC directives: CEE 89/336 (electromagnetic compatibility and CEE 73/23 modified CEE 93/68 (Electric Security).

As a part of the policy of continuous product improvement Elnur S.A reserves the right to alter specifications without notice.